

WYNNERGY MARINE CO.,LTD.

34M Standby Safety Vessel

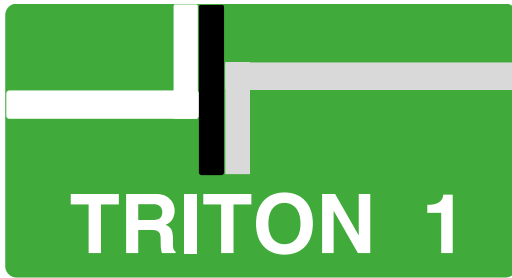

Class LRS 100 A1, LMC

Description notes: Standby Safety Ship
CR

Flag Republic of China

P.O.R Kaohsiung

Year Built 2012

Builder Nam Cheong Dockyard S/B

IMO 9495894

Official Number 016563

Call Sign BR4593

MMSI 416008845

DIMENSION

L.O.A. 34.00 m

Beam 8.00 m

Depth 3.30 m

Draft (max) 2.387 m

GRT 217

NRT 65

CARGO CAPACITIES

Deck Cargo 10 Tonnes

Deck Loading 3.0 Tonnes/m²

Deck Area 84 m²

Fresh Water 43.7 m³

Ballast Water 15.16 m³

Fuel Oil 60.3 m³

Dispersant 7.18 m³

Foam 1.40 m³

ACCOMMODATION

1 Man cabin 2x 1 (2)

3 Men Cabin 2x 3 (6)

4 Men cabin 1x 4 (4)

Total 12 berths

PERFORMANCE

Speed 10kal knots

SAFETY EQUIPMENT

Rescue Boat 1x 6 men Rescue Boat



PROPULSION & POWER PLANT

Propellers 2x 537KW Fixed Pitch Propellers

Bow Thruster 1x 1.0T Thrust each

Main Engine 2x 537KW 1800 rpm

Main Generator 2x 80KW, 415V3Ph50Hz

DECK MACHINERY

Tow Hook 1X5 Tonnes SWL

Capstan 1X3 Tonnes SWL

CARGO HANDLING CAPACITY

Fresh Water 1x 13 m³/hr @ 20 m head

Ballast Water 1x 30 m³/hr @ 30 m head

Fuel Oil 1x 13 m³/hr @ 20 m head

NAVIGATION EQUIPMENT

Radar, Magnetic Compass, Satellite Compasses, GPS, AIS Echo Sounder, Speed Log, Navtex, BNWAS

COMMUNICATION EQUIPMENT

GMDSS A1+A2, VHF Radios, Intercom System, EPIRB
Public Address, SART

FIRE-FIGHTING EQUIPMENT

External FiFi Pump: 1x 1200 m³/hr @ 130 MLC

(Half-FiFi) Monitor: 2x 600 m³/hr (water)

External FiFi Pump: 1x 50 m³/hr @ 100 MLC

(Secondary) Monitor: 1x 50 m³/hr (water/foam)

WYNNERGY MARINE CO.,LTD.



TRITON 1 | 34M Standby Safety Vessel

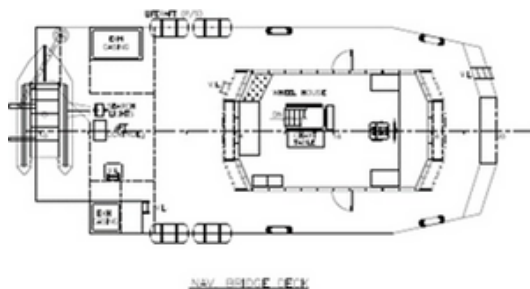
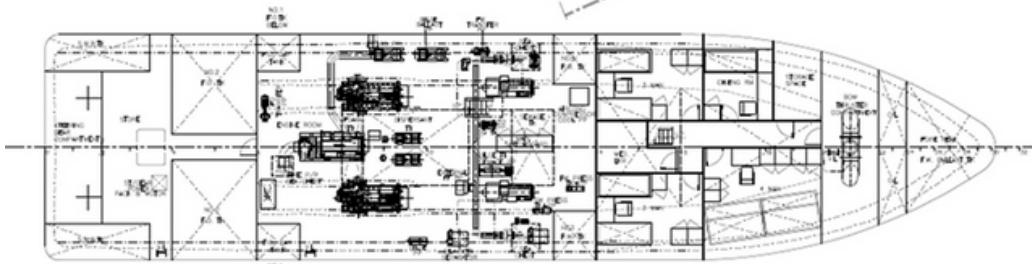
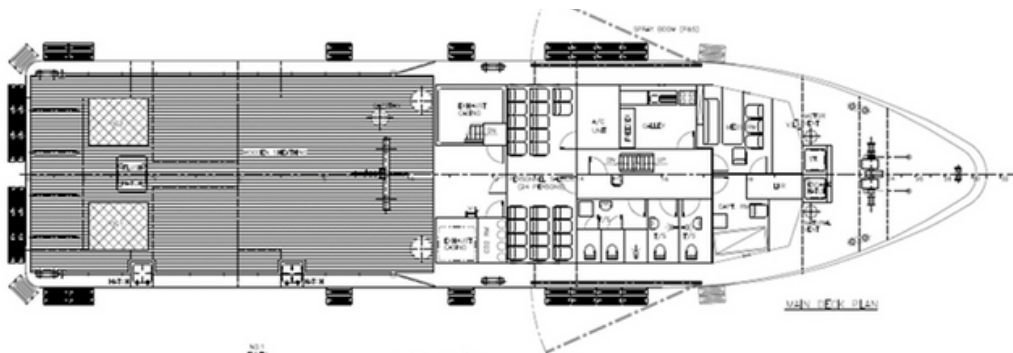
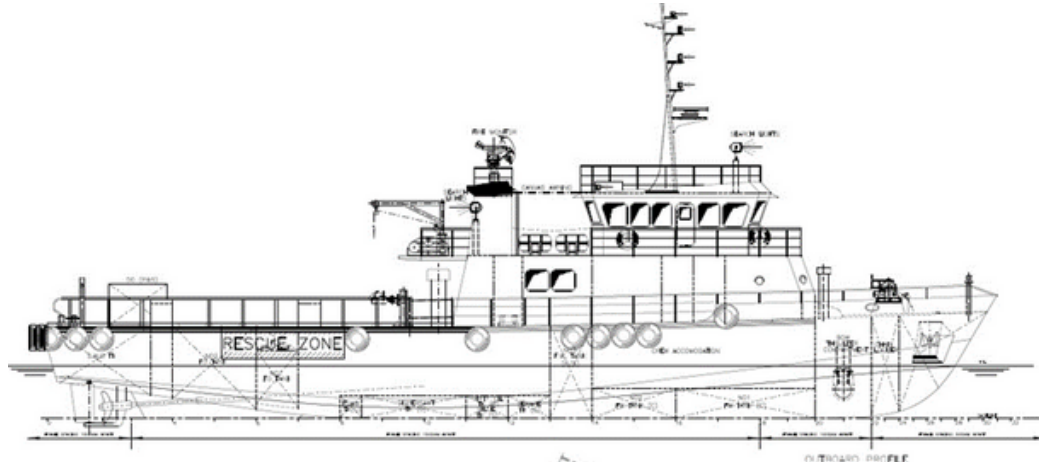

THIS DRAWING AND THE INFORMATION CONTAINED HEREIN ARE SUPPLIED ON THE UNDERSTANDING THAT THEY ARE THE EXCLUSIVE PROPERTY OF SHIPTECH NAVAL ARCHITECTS. THEY MUST NOT BE USED OR REPRODUCED IN WHOLE OR IN PART WITHOUT PERMISSION IN WRITING.